

ELECTRICALLY OPERATED TURNTABLE - R.070

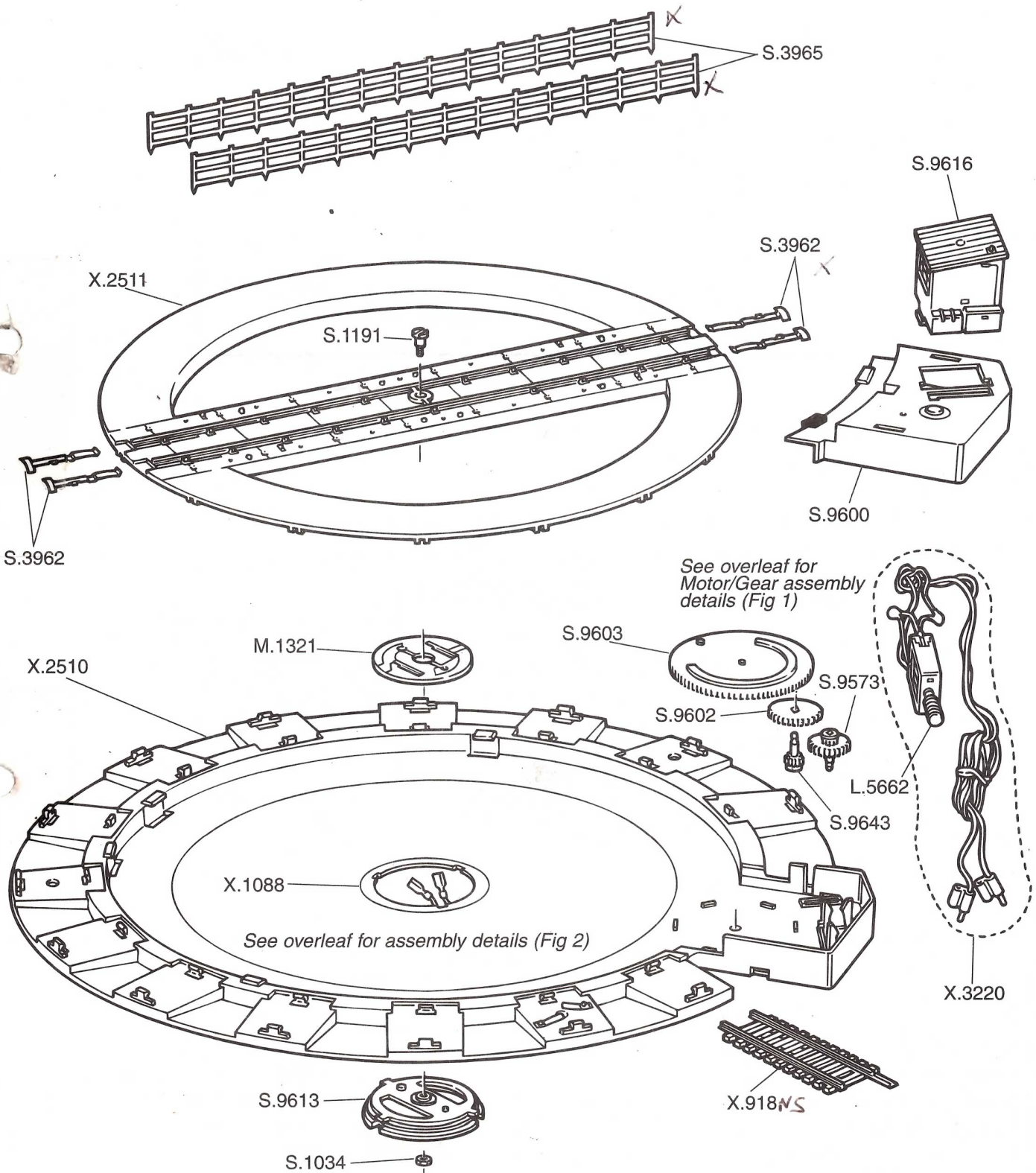

ELECTRICALLY OPERATED TURNTABLE - R.070

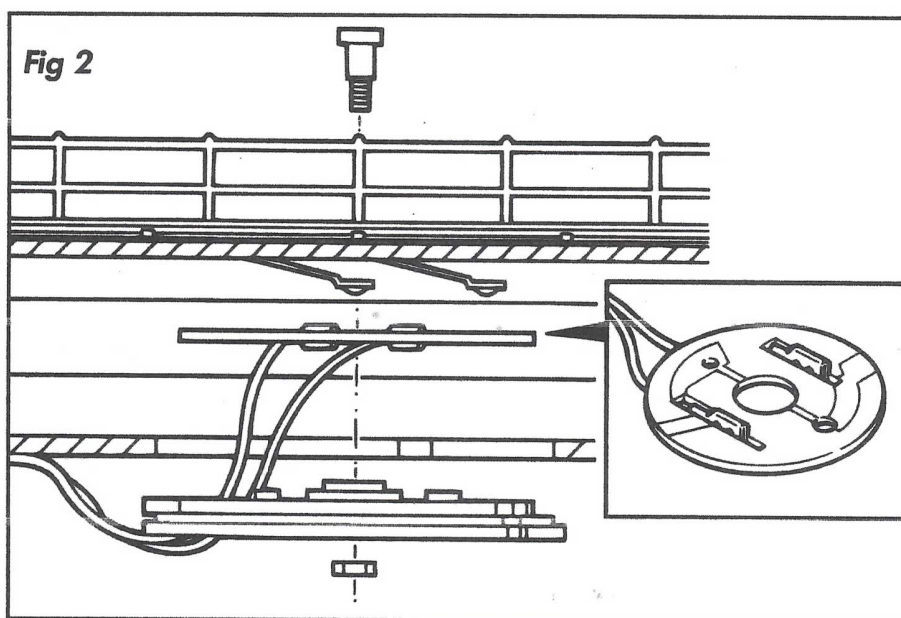
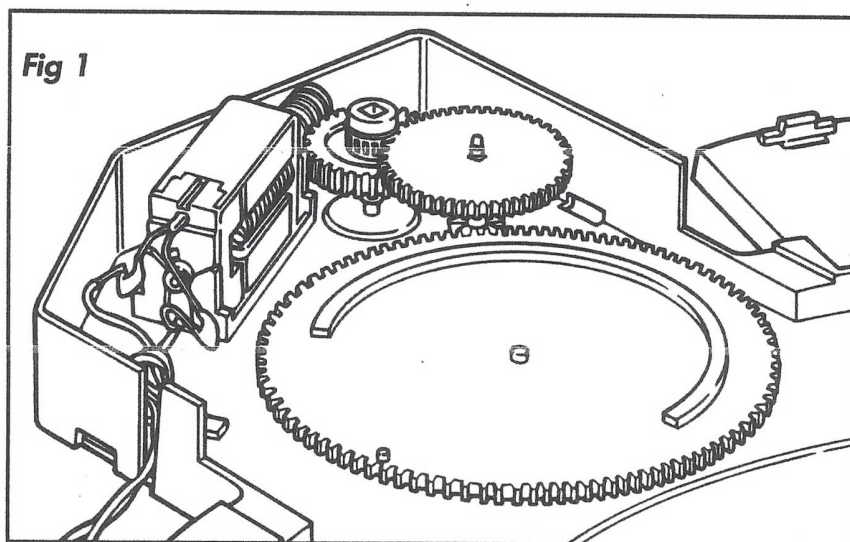

LIST OF PARTS

Ref No.	Item	Ref No.	Item	Ref No.	Item
X.918	Outlet Track	M.1321	P.C.B.	S.9600	Gear Cover
X.1088	Wire Assembly	S.1034	Nut - Centre	S.9602	Gear - 36 Tooth
X.2510	Base Assembly	S.1191	Screw - Centre	S.9603	Gear - Geneva Drive
X.2511	Bridge Assembly	S.3962	Contact - Bridge Rail	S.9613	Centre Disc
X.3220	Motor Assembly	S.3965	Handrails	S.9616	Hut
L.5662	Worm Gear - Single Start	S.9573	Worm Wheel	S.9643	Gear Pinion - 9 Tooth